



Starcraft[®]

PROFESSIONAL TOOLS



ABRASIVES

2601 / DEPRESSED CENTER GRINDING WHEELS (TYPE 27) FOR METAL & STEEL



- Virgin aluminum oxide grain assures consistent high stock removal for tough applications.
- Made with uniform grain throughout, no filler grain used in the backing.
- All wheels internally reinforced with the highest quality fiberglass for maximum safety.
- Depressed center grinding wheels are especially well suited for grinding, weld dressing and deburring.
- Engineered for aggressive stock removal and extra long life.
- All wheels are fully reinforced and meet all relative required safety standards and specifications.
- For grinding metal & steel with Angle Grinder.

ITEM NO.	WHEEL SIZE (DxTxH) INCH/MM	MAX. SPEED R.P.M
26010301P5	4"x1/4"x5/8" 100 x 6 x 16mm	15200
26010302P5	4-1/2"x1/4"x7/8" 115 x 6 x 22mm	13300
26010304P5	5"x1/4"x7/8" 125 x 6 x 22mm	12200

ITEM NO.	WHEEL SIZE (DxTxH) INCH/MM	MAX. SPEED R.P.M
26010304P5	6"x1/4"x7/8" 150 x 6 x 22mm	10200
26010305P5	7"x1/4"x7/8" 180 x 6 x 22mm	8500
26010306P5	9"x1/4"x7/8" 230 x 6 x 22mm	6600

2603 / FLAT CUT-OFF WHEEL (TYPE 41 / US TYPE 1) FOR METAL & STEEL



- Virgin aluminum oxide grain assures consistent high stock removal for tough applications.
- Made with uniform grain throughout, no filler grain used in the backing.
- All wheels internally reinforced with the highest quality fiberglass for maximum safety.
- The flat profile allows for deep cuts.
- Thin cutting wheels deliver accurate, clean cuts.
- Open arbor offers a cost-effective mounting option when using adapting nuts.
- All wheels are fully reinforced and meet all relative required safety standards and specifications.
- Best for use on carbon steel, iron and general purpose metal use.

ITEM NO.	WHEEL SIZE (DxTxH) INCH/MM	MAX. SPEED R.P.M
26030302P10	4" X 3/64" X 5/8" 100 x 1 x 16mm	15200
26030303P10	4" X 1/16" X 5/8" 100 x 1.6 x 16mm	15200
26030304P10	4" X 5/64" X 5/8" 100 x 2.0 x 16mm	15200

ITEM NO.	WHEEL SIZE (DxTxH) INCH/MM	MAX. SPEED R.P.M
26030306P10	4-1/2" X 1/8" X 7/8" 115 X 3X 22mm	13300
26030307P10	4-1/2" X 3/64" X 7/8" 115 X 1 X 22mm	13300
26030308P10	4-1/2" X 1/16" X 7/8" 115 X 1.6 X 22mm	13300

2603 / FLAT CUT-OFF WHEEL (TYPE 41 / US TYPE 1) FOR METAL & STEEL

ITEM NO.	WHEEL SIZE (DxTxH) INCH/MM	MAX. SPEED R.P.M	ITEM NO.	WHEEL SIZE (DxTxH) INCH/MM	MAX. SPEED R.P.M
26030309P10	5" X 1/8" X 7/8" 125 X 3 X 22mm	12200	26030320P5	12" X 1/8" X 1" 305 X 3 X 25.4mm	5100
26030314P10	5" X 3/64" X 7/8" 125 X 1 X 22mm	12200	26030321P5	12" X 5/32" X 7/8" 305 X 4 X 22mm	5100
26030315P10	5" X 1/16" X 7/8" 125 X 1.6 X 22mm	12200	26030322P5	12" X 5/32" X 5/8" 305 X 4 X 20mm	5100
26030316P10	6" X 1/8" X 7/8" 150 X 3 X 22mm	10200	26030323P5	14" X 5/32" X 7/8" 355 X 4 X 22mm	4400
26030317P5	7" X 1/8" X 7/8" 180 X 3 X 22mm	8500	26030324P5	14" X 1/8" X 1" 355 X 3 X 25.4mm	4400
26030318P5	7" X 1/16" X 7/8" 180 X 1.6 X 22mm	8500	26030325P5	16" x 1/8" x 1" 400 X 3 X 25.4mm	3800
26030319P5	9" X 1/8" X 7/8" 230 X 3 X 22mm	6600			

2605 / DEPRESSED CENTER CUT-OFF WHEELS (TYPE 42/US TYPE 27) FOR METAL & STEEL



- Virgin aluminum oxide grain assures consistent high stock removal for tough applications.
- Made with uniform grain throughout, no filler grain used in the backing.
- All wheels internally reinforced with the highest quality fiberglass for maximum safety.
- 1/8" metal depressed center wheels are used primarily for cutting and some light grinding steel and sheet metal.
- All wheels are fully reinforced and meet all relative required safety standards and specifications.
- Best for use on carbon steel, iron and general purpose metal use.

ITEM NO.	WHEEL SIZE (DxTxH) INCH/MM	MAX. SPEED R.P.M	ITEM NO.	WHEEL SIZE (DxTxH) INCH/MM	MAX. SPEED R.P.M
26050301P10	4" x 1/8" x 5/8" 100 x 3 x 16mm	15200	26050306P10	6" x 1/8" x 7/8" 150 x 3 x 22mm	10200
26050302P10	4-1/2 x 1/8" x 7/8" 115 x 3 x 22mm	13300	26050307P10	7" x 1/8" x 7/8" 180 x 3 x 22mm	8500
26050303P10	4-1/2" x 2mm x 7/8" 115 x 2 x 22mm	13300	26050308P5	7" x 2mm x 7/8" 180 x 2 x 22mm	8500
26050304P10	5" x 1/8" x 7/8" 125 x 3 x 22mm	12200	26050309P5	9" x 1/8" x 7/8" 230 x 3 x 22mm	6600
26050305P10	5" x 2mm x 7/8" 125 x 2 x 22mm	12200	26050310P5	9" x 2mm x 7/8" 230 x 2 x 22mm	6600

2606 / DEPRESSED CENTER GRINDING WHEEL (TYPE 27) FOR STONE



- Virgin silicon carbide grain assures consistent high stock removal for tough applications.
- Made with uniform grain throughout, no filler grain used in the backing.
- All wheels internally reinforced with the highest quality fiberglass for maximum safety.
- All wheels are fully reinforced and meet all relative required safety standards and specifications.
- For use with angle grinders only, in stock removal application on stone, concrete, cast iron and non-ferrous metals.

ITEM NO.	WHEEL SIZE (DxTxH) INCH/MM	MAX. SPEED R.P.M
26060301P5	4"x1/4"x5/8" 100 x 6 x 16mm	15200
26060302P5	4-1/2"x1/4"x7/8" 115 x 6 x 22mm	13300
26060303P5	5"x1/4"x7/8" 125 x 6 x 22mm	12200

ITEM NO.	WHEEL SIZE (DxTxH) INCH/MM	MAX. SPEED R.P.M
26060304P5	6"x1/4"x7/8" 150 x 6 x 22mm	10200
26060305P5	7"x1/4"x7/8" 180 x 6 x 22mm	8500
26060306P5	9"x1/4"x7/8" 230 x 6 x 22mm	6600

2607 / DEPRESSED CENTER CUT-OFF WHEEL (TYPE 42) FOR STONE



- Virgin silicon carbide grain assures consistent high stock removal for tough applications.
- Made with uniform grain throughout, no filler grain used in the backing.
- All wheels internally reinforced with the highest quality fiberglass for maximum safety.
- All wheels are fully reinforced and meet all relative required safety standards and specifications.
- For use with angle grinders only, in cutting application on stone, concrete, cast iron and non-ferrous metals.

ITEM NO.	WHEEL SIZE (DxTxH) INCH/MM	MAX. SPEED R.P.M
26070301P10	4" X 1/8" X 5/8" 100 X 3 X 16 mm	15200
26070302P10	4-1/2" X 1/8" X 7/8" 115 X 3 X 22mm	15200
26070303P10	4-1/2" X 2mm X 7/8" 115 X 2 X 22mm	13300
26070304P10	5" x 1/8" x 7/8" 125 X 3 X 22mm	12200
26070305P10	5" X 2mm X 7/8" 125 x 2 x 22mm	12200

ITEM NO.	WHEEL SIZE (DxTxH) INCH/MM	MAX. SPEED R.P.M
26070306P10	6" X 1/8" X 7/8" 150 X 3 X 22mm	10200
26070307P5	7" X 1/8" X 7/8" 180 X 3 X 22mm	8500
26070308P5	7" X 2mm X 7/8" 180 X 2 X 22mm	8500
26070309P5	9" X 1/8" X 7/8" 230 X 3 X 22mm	13300
26070310P5	9" X 2mm X 7/8" 230 X 2 X 22mm	13300

2608 / FLAT CUT-OFF WHEEL (TYPE 41 /US TYPE 1) FOR STONE



- Virgin silicon carbide grain assures consistent high stock removal for tough applications.
- Made with uniform grain throughout, no filler grain used in the backing.
- All wheels internally reinforced with the highest quality fiberglass for maximum safety.
- The flat profile allows for deep cuts.
- All wheels are fully reinforced and meet all relative required safety standards and specifications.
- Used mainly for cutting stone, masonry bricks and blocks, concrete, asphalt, plexiglass, fiberglass and tile. It can also be used for cutting non-ferrous metals such as brass and copper.

ITEM NO.	WHEEL SIZE (DxTxH) INCH/MM	MAX. SPEED R.P.M
26080301P10	4" X 2mm X 5/8" 100 X 2 X 16mm	15200
26080302P10	4-1/2" X 1/8" X 7/8" 115 X 3 X 22mm	13300
26080303P10	4-1/2" X 1/16" X 7/8" 115 X 1.6 X 22mm	13300
26080304P10	5" X 1/8" X 7/8" 125 X 3 X 22mm	12200
26080305P10	5" X 1/16" X 7/8" 125 X 1.6 X 22mm	12200
26080306P10	6" X 1/8" X 7/8" 150 X 3 X 22mm	10200
26080307P5	7" X 1/8" X 7/8" 180 X 3 X 22mm	8500

ITEM NO.	WHEEL SIZE (DxTxH) INCH/MM	MAX. SPEED R.P.M
26080308P5	7" X 2mm X 7/8" 180 X 2 X 22 mm	10200
26080309P5	8" X 1/8" X 7/8" 200 X 3 X 22mm	7460
26080310P5	9" X 1/8" X 7/8" 230 X 3 X 22mm	6600
26080311P5	12" X 1/8" X 1" 305 X 3 X 25.4mm	5100
26080312P5	14" X 1/8" X 1" 355 X 3 X 25.4mm	4400
26080313P5	16" X 1/8" X 1" 400 X 3 X 25.4mm	3800

2609 / FLAT CUT-OFF WHEEL (TYPE 41 /US TYPE 1) FOR STAINLESS STEEL



- Virgin white aluminum oxide grain assures consistent high stock removal for tough applications.
- Made with uniform grain throughout, no filler grain used in the backing.
- All wheels internally reinforced with the highest quality fiberglass for maximum safety.
- The flat profile allows for deep cuts.
- Thin cutting wheels deliver accurate, clean cuts.
- Open arbor offers a cost-effective mounting option when using adapting nuts.
- All wheels are fully reinforced and meet all relative required safety standards and specifications.
- Best for use on stainless steel, ferrous metal, iron, steel, sheet metals.

2609 / FLAT CUT-OFF WHEEL (TYPE 41 / US TYPE 1) FOR STAINLESS STEEL

ITEM NO.	WHEEL SIZE (DxTxH) INCH/MM	MAX. SPEED R.P.M	ITEM NO.	WHEEL SIZE (DxTxH) INCH/MM	MAX. SPEED R.P.M
26090301P10	4" X 3/64" X 5/8" 100 X 1 X 16mm	15200	26090307P10	5" X 1/16" X 7/8" 125 X 1.6 X 22mm	12200
26090302P10	4" X 1/16" X 5/8" 100 X 1.6 X 16mm	15200	26090308P10	6" X 3/64" X 7/8" 150 X 1 X 22mm	10200
26090303P10	4-1/2" X 3/64" X 7/8" 115 X 1 X 22mm	13300	26090309P10	6" X 1/16" X 7/8" 150 X 1.6 X 22mm	10200
26090304P10	4-1/2" X 3/64" X 7/8" 115 X 1.2 X 22mm	13300	26090310P5	7" X 1/16" X 7/8" 180 X 1.6 X 22mm	8500
26090305P10	4-1/2" X 1/16" X 7/8" 115 X 1.6 X 22mm	13300	26090311P5	7" X 2mm X 7/8" 180 X 2 X 22mm	8500
26090306P10	5" X 3/64" X 7/8" 125 X 1 X 22mm	12200	26090312P5	9" X 2mm X 7/8" 230 X 2 X 22mm	6600

2610 / DEPRESS CENTER CUT-OFF WHEEL (TYPE 42) FOR STAINLESS STEEL



- Virgin white aluminum oxide grain assures consistent high stock removal for tough applications.
- Made with uniform grain throughout, no filler grain used in the backing.
- All wheels internally reinforced with the highest quality fiberglass for maximum safety.
- 1/8" metal depressed center wheels are used primarily for cutting and some light grinding steel and sheet metal.
- All wheels are fully reinforced and meet all relative required safety standards and specifications.
- Best for use on stainless steel, ferrous metal, iron, steel, sheet metals.

ITEM NO.	WHEEL SIZE (DxTxH) INCH/MM	MAX. SPEED R.P.M	ITEM NO.	WHEEL SIZE (DxTxH) INCH/MM	MAX. SPEED R.P.M
26100301P10	4" X 1/8" X 5/8" 100 X 3 X 16mm	15200	26100306P10	6" X 1/8" X 7/8" 150 X 3 X 22mm	10200
26100302P10	4-1/2" X 1/8" X 7/8" 115 X 3 X 22mm	13300	26100307P5	7" X 1/8" X 7/8" 180 X 3 X 22mm	8500
26100303P10	4-1/2" X 2mm X 7/8" 115 X 2 X 22mm	13300	26100308P5	7" X 2mm X 7/8" 180 X 2 X 22mm	8500
26100304P10	5" X 1/8" X 7/8" 125 X 3 X 22mm	12200	26100309P5	9" X 1/8" X 7/8" 230 X 3 X 22mm	6600
26100305P10	5" X 2mm X 7/8" 125 X 2 X 22mm	12200	26100310P5	9" X 2mm X 7/8" 230 X 2 X 22mm	6600

2611 / DEPRESS CENTER GRINDING WHEEL (TYPE 27) FOR STAINLESS STEEL



- *Virgin white aluminum oxide grain assures consistent high stock removal for tough applications.
- *Made with uniform grain throughout, no filler grain used in the backing.
- *All wheels internally reinforced with the highest quality fiberglass for maximum safety.
- *Depressed center grinding wheels are especially well suited for grinding, weld dressing and deburring.
- *Engineered for aggressive stock removal and extra long life.
- *All wheels are fully reinforced and meet all relative required safety standards and specifications.
- *Best for use on stainless steel, ferrous metal, iron, steel, sheet metals.

ITEM NO.	WHEEL SIZE (DxTxH) INCH/MM	MAX. SPEED R.P.M
26110301P10	4"x1/4"x5/8" 100x6.5x16mm	15200
26110302P5	4-1/2"x1/4"x7/8" 115x6.5x22.23mm	13300
26110303P5	5"x1/4"x7/8" 125x6.5x22.23mm	13300

ITEM NO.	WHEEL SIZE (DxTxH) INCH/MM	MAX. SPEED R.P.M
26110304P5	6"x1/4"x7/8" 150x6.5x22.23mm	10200
26110305P5	7"x1/4"x7/8" 180x6.5x22.23mm	7460
26110306P5	9"x1/4"x7/8" 230x6.5x22.23mm	6600



**INDIVIDUAL PACKAGE
DISPLAY**

2681 / CUP BRUSH, KNOTTED, SINGLE ROW

- Rigid structure for High impact cutting and cleaning.
- Knotted Cup – single row, twist knot construction limits flaring of the brush on corners and angles.
- High-impact cutting and cleaning on more demanding applications such as heavy deburring, weld cleaning and cleaning larger surfaces.

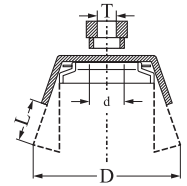

TEMPERED STEEL WIRE		STAINLESS STEEL WIRE		DIA. (MM)	TRIM LENGTH (MM)	SPECIFICATION T	ARBOR (MM)
0.35MM ITEM NO.	0.50MM ITEM NO.	0.35MM ITEM NO.	0.50MM ITEM NO.				
26810101E/26810101C	26810150E/26810150C	26810301E/26810301C	26810350E/26810350C	65	20	-	16
26810102E/26810102C	26810151E/26810151C	26810302E/26810302C	26810351E/26810351C	65	20	M10x1.5	-
26810103E/26810103C	26810152E/26810152C	26810303E/26810303C	26810352E/26810352C	65	20	M10x1.25	-
26810104E/26810104C	26810153E/26810153C	26810304E/26810304C	26810353E/26810353C	65	20	M14x2	-
26810105E/26810105C	26810154E/26810154C	26810305E/26810305C	26810354E/26810354C	65	20	5/8"-11	-
26810106E/26810106C	26810155E/26810155C	26810306E/26810306C	26810355E/26810355C	75	25	-	22.2
26810107E/26810107C	26810156E/26810156C	26810307E/26810307C	26810356E/26810356C	75	25	M10x1.5	-
26810108E/26810108C	26810157E/26810157C	26810308E/26810308C	26810357E/26810357C	75	25	M10x1.25	-
26810109E/26810109C	26810158E/26810158C	26810309E/26810309C	26810358E/26810358C	75	25	M14x2	-
26810110E/26810110C	26810159E/26810159C	26810310E/26810310C	26810359E/26810359C	75	25	5/8"-11	-
26810111E/26810111C	26810160E/26810160C	26810311E/26810311C	26810360E/26810360C	80	25	-	22.2
26810112E/26810112C	26810161E/26810161C	26810312E/26810312C	26810361E/26810361C	80	25	M10x1.5	-
26810113E/26810113C	26810162E/26810162C	26810313E/26810313C	26810362E/26810362C	80	25	M10x1.25	-
26810114E/26810114C	26810163E/26810163C	26810314E/26810314C	26810363E/26810363C	80	25	M14x2	-
26810115E/26810115C	26810164E/26810164C	26810315E/26810315C	26810364E/26810364C	80	25	5/8"-11	-
26810116E/26810116C	26810165E/26810165C	26810316E/26810316C	26810365E/26810365C	90	25	-	22.2
26810117E/26810117C	26810166E/26810166C	26810317E/26810317C	26810366E/26810366C	90	25	M10x1.5	-
26810118E/26810118C	26810167E/26810167C	26810318E/26810318C	26810367E/26810367C	90	25	M10x1.25	-
26810119E/26810119C	26810168E/26810168C	26810319E/26810319C	26810368E/26810368C	90	25	M14x2	-
26810120E/26810120C	26810169E/26810169C	26810320E/26810320C	26810369E/26810369C	90	25	5/8"-11	-
26810121E/26810121C	26810170E/26810170C	26810321E/26810321C	26810370E/26810370C	100	25	-	22.2
26810122E/26810122C	26810171E/26810171C	26810322E/26810322C	26810371E/26810371C	100	25	M10x1.5	-
26810123E/26810123C	26810172E/26810172C	26810323E/26810323C	26810372E/26810372C	100	25	M10x1.25	-
26810124E/26810124C	26810173E/26810173C	26810324E/26810324C	26810373E/26810373C	100	25	M14x2	-
26810125E/26810125C	26810174E/26810174C	26810325E/26810325C	26810374E/26810374C	100	25	5/8"-11	-
26810126E/26810126C	26810175E/26810175C	26810326E/26810326C	26810375E/26810375C	125	30	-	22.2
26810127E/26810127C	26810176E/26810176C	26810327E/26810327C	26810376E/26810376C	125	30	M10x1.5	-
26810128E/26810128C	26810177E/26810177C	26810328E/26810328C	26810377E/26810377C	125	30	M10x1.25	-
26810129E/26810129C	26810178E/26810178C	26810329E/26810329C	26810378E/26810378C	125	30	M14x2	-
26810130E/26810130C	26810179E/26810179C	26810330E/26810330C	26810379E/26810379C	125	30	5/8"-11	-
26810131E/26810131C	26810180E/26810180C	26810331E/26810331C	26810380E/26810380C	150	30	5/8"-11	-
26810132E/26810132C	26810181E/26810181C	26810332E/26810332C	26810381E/26810381C	150	30	M10x1.5	-
26810133E/26810133C	26810182E/26810182C	26810333E/26810333C	26810382E/26810382C	150	30	M10x1.25	-
26810134E/26810134C	26810183E/26810183C	26810334E/26810334C	26810383E/26810383C	150	30	M14x2	-
26810135E/26810135C	26810184E/26810184C	26810335E/26810335C	26810384E/26810384C	150	30	5/8"-11	-

2621 TWIST KNOT WIRE CUP BRUSH WITH BRIDLE

- Rigid structure for High impact cutting and cleaning.
- Knotted Cup – single row, twist knot construction limits flaring of the brush on corners and angles.
- High-impact cutting and cleaning on more demanding applications such as heavy deburring, weld cleaning and cleaning larger surfaces.
- Equipped with metal bridle to eliminate flaring for easier control when brushing.
- Ideal for heavy-duty cleaning of metal surfaces. Used to remove rust, scale, paint or other adherences on flat or irregular surfaces.

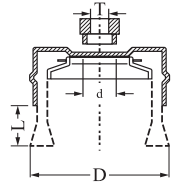

TEMPERED STEEL WIRE		STAINLESS STEEL WIRE		DIA. (MM)	TRIM LENGTH (MM)	SPECIFICATION T	ARBOR (MM)
0.35MM ITEM NO.	0.50MM ITEM NO.	0.35MM ITEM NO.	0.50MM ITEM NO.				
26210101E/26210101C	26210150E/26210150C	26210301E/26210301C	26210350E/26210350C	65	20	-	16
26210102E/26210102C	26210151E/26210151C	26210302E/26210302C	26210351E/26210351C	65	20	M10x1.5	-
26210103E/26210103C	26210152E/26210152C	26210303E/26210303C	26210352E/26210352C	65	20	M10x1.25	-
26210104E/26210104C	26210153E/26210153C	26210304E/26210304C	26210353E/26210353C	65	20	M14x2	-
26210105E/26210105C	26210154E/26210154C	26210305E/26210305C	26210354E/26210354C	65	20	5/8"-11	-
26210106E/26210106C	26210155E/26210155C	26210306E/26210306C	26210355E/26210355C	75	25	-	22.2
26210107E/26210107C	26210156E/26210156C	26210307E/26210307C	26210356E/26210356C	75	25	M10x1.5	-
26210108E/26210108C	26210157E/26210157C	26210308E/26210308C	26210357E/26210357C	75	25	M10x1.25	-
26210109E/26210109C	26210158E/26210158C	26210309E/26210309C	26210358E/26210358C	75	25	M14x2	-
26210110E/26210110C	26210159E/26210159C	26210310E/26210310C	26210359E/26210359C	75	25	5/8"-11	-
26210111E/26210111C	26210160E/26210160C	26210311E/26210311C	26210360E/26210360C	80	25	-	22.2
26210112E/26210112C	26210161E/26210161C	26210312E/26210312C	26210361E/26210361C	80	25	M10x1.5	-
26210113E/26210113C	26210162E/26210162C	26210313E/26210313C	26210362E/26210362C	80	25	M10x1.25	-
26210114E/26210114C	26210163E/26210163C	26210314E/26210314C	26210363E/26210363C	80	25	M14x2	-
26210115E/26210115C	26210164E/26210164C	26210315E/26210315C	26210364E/26210364C	80	25	5/8"-11	-
26210116E/26210116C	26210165E/26210165C	26210316E/26210316C	26210365E/26210365C	90	25	-	22.2
26210117E/26210117C	26210166E/26210166C	26210317E/26210317C	26210366E/26210366C	90	25	M10x1.5	-
26210118E/26210118C	26210167E/26210167C	26210318E/26210318C	26210367E/26210367C	90	25	M10x1.25	-
26210119E/26210119C	26210168E/26210168C	26210319E/26210319C	26210368E/26210368C	90	25	M14x2	-
26210120E/26210120C	26210169E/26210169C	26210320E/26210320C	26210369E/26210369C	90	25	5/8"-11	-
26210121E/26210121C	26210170E/26210170C	26210321E/26210321C	26210370E/26210370C	100	25	-	22.2
26210122E/26210122C	26210171E/26210171C	26210322E/26210322C	26210371E/26210371C	100	25	M10x1.5	-
26210123E/26210123C	26210172E/26210172C	26210323E/26210323C	26210372E/26210372C	100	25	M10x1.25	-
26210124E/26210124C	26210173E/26210173C	26210324E/26210324C	26210373E/26210373C	100	25	M14x2	-
26210125E/26210125C	26210174E/26210174C	26210325E/26210325C	26210374E/26210374C	100	25	5/8"-11	-
26210126E/26210126C	26210175E/26210175C	26210326E/26210326C	26210375E/26210375C	125	30	-	22.2
26210127E/26210127C	26210176E/26210176C	26210327E/26210327C	26210376E/26210376C	125	30	M10x1.5	-
26210128E/26210128C	26210177E/26210177C	26210328E/26210328C	26210377E/26210377C	125	30	M10x1.25	-
26210129E/26210129C	26210178E/26210178C	26210329E/26210329C	26210378E/26210378C	125	30	M14x2	-
26210130E/26210130C	26210179E/26210179C	26210330E/26210330C	26210379E/26210379C	125	30	5/8"-11	-
26210131E/26210131C	26210180E/26210180C	26210331E/26210331C	26210380E/26210380C	150	30	5/8"-11	-
26210132E/26210132C	26210181E/26210181C	26210332E/26210332C	26210381E/26210381C	150	30	M10x1.5	-
26210133E/26210133C	26210182E/26210182C	26210333E/26210333C	26210382E/26210382C	150	30	M10x1.25	-
26210134E/26210134C	26210183E/26210183C	26210334E/26210334C	26210383E/26210383C	150	30	M14x2	-
26210135E/26210135C	26210184E/26210184C	26210335E/26210335C	26210384E/26210384C	150	30	5/8"-11	-

2662 / KNOT WIRE WHEEL BRUSH

- These wheels are used in surface preparation prior to welding.
- Used for heavy duty cleaning applications.
- Also great for removing weld scale, spatter and heavy corrosion.
- Twist knot construction provide high impact brushing for faster
- removal rates on tougher jobs.
- Aggressive brushing action for general purpose deburring, cleaning and surface preparation applications.

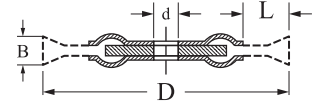

TEMPERED STEEL WIRE		STAINLESS STEEL WIRE		SPECIFICATION			
0.35MM ITEM NO.	0.50MM ITEM NO.	0.35MM ITEM NO.	0.50MM ITEM NO.	DIA. (MM)	TRIM LENGTH (MM)	B (MM)	ARBOR (MM)
26620101E/26620101C	26620150E/26620150C	26620301E/26620301C	26620350E/26620350C	75	10	16	9.5/13
26620102E/26620102C	26620151E/26620151C	26620302E/26620302C	26620351E/26620351C	85	10	21	9.5/13
26620103E/26620103C	26620152E/26620152C	26620303E/26620303C	26620352E/26620352C	100	14	22	13/22.2
26620104E/26620104C	26620153E/26620153C	26620304E/26620304C	26620353E/26620353C	115	15	30	13/22.2
26620105E/26620105C	26620154E/26620154C	26620305E/26620305C	26620354E/26620354C	125	16	26	13/22.2
26620106E/26620106C	26620155E/26620155C	26620306E/26620306C	26620355E/26620355C	150	16	30	13/22.2
26620107E/26620107C	26620156E/26620156C	26620307E/26620307C	26620356E/26620356C	175	18	36	22.2/25.4
26620108E/26620108C	26620157E/26620157C	26620308E/26620308C	26620357E/26620357C	180	18	38	22.2/25.5
26620109E/26620109C	26620158E/26620158C	26620309E/26620309C	26620358E/26620358C	200	18	40	22.2/25.6
26620110E/26620110C	26620159E/26620159C	26620310E/26620310C	26620359E/26620359C	250	20	50	22.2/25.7
26620111E/26620111C	26620160E/26620160C	26620311E/26620311C	26620360E/26620360C	300	22	35	22.2/25.8

2677 / STEM MOUNTED KNOTTED WIRE END BRUSH

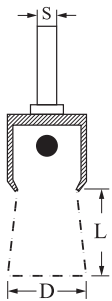

- Tightly-twisted knots result in very aggressive brushing action.
- Reduced flare for more precise surface contact.
- Ideal for tough brushing applications.
- For weld cleaning, weld spatter removal, scale removal, cleaning, deburring, and flash removal.
- Designed for use on straight grinders and power drills.

TEMPERED STEEL WIRE		SPECIFICATION		
0.35MM ITEM NO.	0.50MM ITEM NO.	DIA. (MM)	TRIM LENGTH (MM)	ARBOR (MM)
26770101E/26770101C	26770150E/26770150C	19	25	6
26770102E/26770102C	26770151E/26770151C	25	28	6
26770103E/26770103C	26770152E/26770152C	30	28	6

2679 / STEM MOUNTED KNOTTED WIRE CUP BRUSH



- Tightly-twisted knots result in very aggressive brushing action.
- Tightly twisted knots for low flex, high impact brushing action.
- Full cable twist is ideal for tough brushing applications.
- For weld cleaning, weld spatter removal, scale removal, cleaning, deburring, and flash removal.
- Designed for use on straight grinders and power drills.

TEMPERED STEEL WIRE		SPECIFICATION		
0.35MM ITEM NO.	0.50MM ITEM NO.	DIA. (MM)	TRIM LENGTH (MM)	ARBOR (MM)
26790101E/26790101C	26790150E/26790150C	65	18	6
26790102E/26790102C	26790151E/26790151C	75	20	6
26790103E/26790103C	26790152E/26790152C	80	21	6



2680 / STEM MOUNTED KNOTTED WIRE WHEEL BRUSH

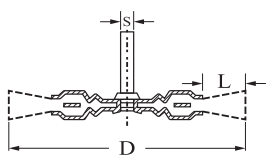

- Loosely-twisted knots cover a large surface area.
- Good balance between aggressiveness and flexibility.
- Ideal for heavy-duty cleaning and surface conditioning on uneven surfaces.
- For weld cleaning, weld spatter removal, scale removal.
- Designed for use on straight grinders and power drills.

TEMPERED STEEL WIRE		SPECIFICATION		
0.35MM ITEM NO.	0.50MM ITEM NO.	DIA. (MM)	TRIM LENGTH (MM)	ARBOR (MM)
26800101E/26800101C	26800150E/26800150C	75	15	6
26800102E/26800102C	26800151E/26800151C	85	20	6
26800103E/26800103C	26800152E/26800152C	100	21	6
26800104E/26800104C	26800153E/26800153C	115	28	6

2665 / KNOTTED WIRE BEVEL BRUSH

- Tightly twisted knots for low flex, high impact brushing action.
- Full cable twist is ideal for tough brushing applications.
- Tightly-twisted knots result in very aggressive brushing action.
- Ideal for cleaning narrow or hard-to-reach areas such as grooves, fillets, and inside edges.
- For weld cleaning, weld spatter removal, scale removal, cleaning, deburring, and flash removal.
- Designed for use on right angle grinders.

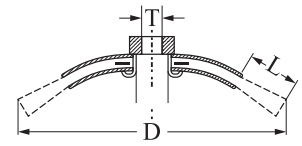

TEMPERED STEEL WIRE		STAINLESS STEEL WIRE		DIA. (MM)	SPECIFICATION TRIM LENGTH (MM)	ARBOR (MM)
0.35MM ITEM NO.	0.50MM ITEM NO.	0.35MM ITEM NO.	0.50MM ITEM NO.			
26650101E/26650101C	26650150E/26650150C	26650301E/26650301C	26650350E/26650350C	85	14	M10x1.5
26650102E/26650102C	26650151E/26650151C	26650302E/26650302C	26650351E/26650351C	85	14	M10x1.25
26650103E/26650103C	26650152E/26650152C	26650303E/26650303C	26650352E/26650352C	85	14	M14x2
26650104E/26650104C	26650153E/26650153C	26650304E/26650304C	26650353E/26650353C	85	14	5/8"-11
26650105E/26650105C	26650154E/26650154C	26650305E/26650305C	26650354E/26650354C	100	20	M10x1.5
26650106E/26650106C	26650155E/26650155C	26650306E/26650306C	26650355E/26650355C	100	20	M10x1.25
26650107E/26650107C	26650156E/26650156C	26650307E/26650307C	26650356E/26650356C	100	20	M14x2
26650108E/26650108C	26650157E/26650157C	26650308E/26650308C	26650357E/26650357C	100	20	5/8"-11
26650109E/26650109C	26650158E/26650158C	26650309E/26650309C	26650358E/26650358C	115	27.5	M10x1.5
26650110E/26650110C	26650159E/26650159C	26650310E/26650310C	26650359E/26650359C	115	27.5	M10x1.25
26650111E/26650111C	26650160E/26650160C	26650311E/26650311C	26650360E/26650360C	115	27.5	M14x2
26650112E/26650112C	26650161E/26650161C	26650312E/26650312C	26650361E/26650361C	115	27.5	5/8"-11
26650113E/26650113C	26650162E/26650162C	26650313E/26650313C	26650362E/26650362C	125	32	M10x1.5
26650114E/26650114C	26650163E/26650163C	26650314E/26650314C	26650363E/26650363C	125	32	M10x1.25
26650115E/26650115C	26650164E/26650164C	26650315E/26650315C	26650364E/26650364C	125	32	M14x2
26650116E/26650116C	26650165E/26650165C	26650316E/26650316C	26650365E/26650365C	125	32	5/8"-11

2676 / STEM MOUNTED CRIMPED WIRE END BRUSH

- Highly flexible, enabling optimal adjustment to workpiece contours.
- Ideal for brushing uneven surfaces.
- Used for light to medium duty brushing action such as removal of light scale, dirt, rust, corrosion and light burrs.
- Designed for use on straight grinders and power drills.

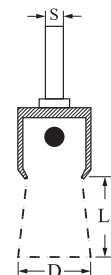

2676 / STEM MOUNTED CRIMPED WIRE END BRUSH

TEMPERED STEEL WIRE 0.30MM ITEM NO.	BRASS-COATED STEEL WIRE 0.30MM ITEM NO.	BRASS WIRE 0.30MM ITEM NO.	STAINLESS STEEL WIRE 0.30MM ITEM NO.	DIA. (MM)	SPECIFICATION TRIM LENGTH (MM)	ARBOR (MM)
26760101E/26760101C	26760201E/26760201C	26760250E/26760250C	26760301E/26760301C	12	20	6
26760102E/26760102C	26760202E/26760202C	26760251E/26760251C	26760302E/26760302C	17	22	6
26760103E/26760103C	26760203E/26760203C	26760252E/26760252C	26760303E/26760303C	25	28	6
26760104E/26760104C	26760204E/26760204C	26760253E/26760253C	26760304E/26760304C	30	25	6

2666 / CRIMPED WIRE BEVEL BRUSH

- Highly flexible, enabling optimal adjustment to workpiece contours.
- Ideal for cleaning narrow or hard-to-reach areas such as grooves, fillets, and inside edges.
- Ideal for brushing uneven surfaces.
- Used for light to medium duty brushing action such as removal of light scale, dirt, rust, corrosion and light burrs.
- Designed for use on right angle grinders.

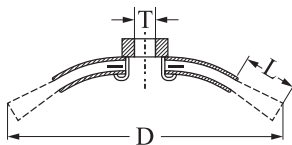

TEMPERED STEEL WIRE 0.30MM ITEM NO.	0.35MM ITEM NO.	BRASS-COATED STEEL WIRE 0.30MM ITEM NO.	0.35MM ITEM NO.	STAINLESS STEEL WIRE 0.30MM ITEM NO.	0.35MM ITEM NO.	SPECIFICATION DIA. TRIM LENGTH (MM) (MM)	ARBOR (MM)
26660101E/26660101C	26660150E/26660150C	26660201E/26660201C	26660250E/26660250C	26660301E/26660301C	26660350E/26660350C	85 14	M10x1.5
26660102E/26660102C	26660151E/26660151C	26660202E/26660202C	26660251E/26660251C	26660302E/26660302C	26660351E/26660351C	85 14	M10x1.25
26660103E/26660103C	26660152E/26660152C	26660203E/26660203C	26660252E/26660252C	26660303E/26660303C	26660352E/26660352C	85 14	M14x2
26660104E/26660104C	26660153E/26660153C	26660204E/26660204C	26660253E/26660253C	26660304E/26660304C	26660353E/26660353C	85 14	5/8"-11
26660105E/26660105C	26660154E/26660154C	26660205E/26660205C	26660254E/26660254C	26660305E/26660305C	26660354E/26660354C	100 20	M10x1.5
26660106E/26660106C	26660155E/26660155C	26660206E/26660206C	26660255E/26660255C	26660306E/26660306C	26660355E/26660355C	100 20	M10x1.25
26660107E/26660107C	26660156E/26660156C	26660207E/26660207C	26660256E/26660256C	26660307E/26660307C	26660356E/26660356C	100 20	M14x2
26660108E/26660108C	26660157E/26660157C	26660208E/26660208C	26660257E/26660257C	26660308E/26660308C	26660357E/26660357C	100 20	5/8"-11
26660109E/26660109C	26660158E/26660158C	26660209E/26660209C	26660258E/26660258C	26660309E/26660309C	26660358E/26660358C	115 27.5	M10x1.5
26660110E/26660110C	26660159E/26660159C	26660210E/26660210C	26660259E/26660259C	26660310E/26660310C	26660359E/26660359C	115 27.5	M10x1.25
26660111E/26660111C	26660160E/26660160C	26660211E/26660211C	26660260E/26660260C	26660311E/26660311C	26660360E/26660360C	115 27.5	M14x2
26660112E/26660112C	26660161E/26660161C	26660212E/26660212C	26660261E/26660261C	26660312E/26660312C	26660361E/26660361C	115 27.5	5/8"-11
26660113E/26660113C	26660162E/26660162C	26660213E/26660213C	26660262E/26660262C	26660313E/26660313C	26660362E/26660362C	125 32	M10x1.5
26660114E/26660114C	26660163E/26660163C	26660214E/26660214C	26660263E/26660263C	26660314E/26660314C	26660363E/26660363C	125 32	M10x1.25
26660115E/26660115C	26660164E/26660164C	26660215E/26660215C	26660264E/26660264C	26660315E/26660315C	26660364E/26660364C	125 32	M14x2
26660116E/26660116C	26660165E/26660165C	26660216E/26660216C	26660265E/26660265C	26660316E/26660316C	26660365E/26660365C	125 32	5/8"-11

2667 / CRIMPED WIRE CUP BRUSH

- Top grade wire for long service life and reduced wire breakage.
- Removal of burrs, weld scale, corrosion, paint, etc.
- Softer impact and more flexible than knotted style.
- For light- to medium-duty brushing applications on flat or irregular surfaces, and bevel buffing.
- For Steel/Metal.

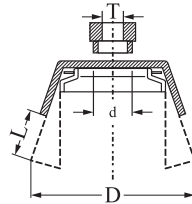

0.20MM ITEM NO.	TEMPERED STEEL WIRE		BRASS-COATED STEEL WIRE		DIA. (MM)	TRIM LENGTH (MM)	SPECIFICATION T	ARBOR (MM)
	0.30MM ITEM NO.	0.35MM ITEM NO.	0.20MM ITEM NO.	0.30MM ITEM NO.				
26670101E/26670101C	26670131E/26670131C	26670161E/26670161C	26670201E/26670201C	26670231E/26670231C	65	20	-	16
26670102E/26670102C	26670132E/26670132C	26670162E/26670162C	26670202E/26670202C	26670232E/26670232C	65	20	M10x1.5	-
26670103E/26670103C	26670133E/26670133C	26670163E/26670163C	26670203E/26670203C	26670233E/26670233C	65	20	M10x1.25	-
26670104E/26670104C	26670134E/26670134C	26670164E/26670164C	26670204E/26670204C	26670234E/26670234C	65	20	M14x2	-
26670105E/26670105C	26670135E/26670135C	26670165E/26670165C	26670205E/26670205C	26670235E/26670235C	65	20	5/8"-11	-
26670106E/26670106C	26670136E/26670136C	26670166E/26670166C	26670206E/26670206C	26670236E/26670236C	75	25	-	22.2
26670107E/26670107C	26670137E/26670137C	26670167E/26670167C	26670207E/26670207C	26670237E/26670237C	75	25	M10x1.5	-
26670108E/26670108C	26670138E/26670138C	26670168E/26670168C	26670208E/26670208C	26670238E/26670238C	75	25	M10x1.25	-
26670109E/26670109C	26670139E/26670139C	26670169E/26670169C	26670209E/26670209C	26670239E/26670239C	75	25	M14x2	-
26670110E/26670110C	26670140E/26670140C	26670170E/26670170C	26670210E/26670210C	26670240E/26670240C	75	25	5/8"-11	-
26670111E/26670111C	26670141E/26670141C	26670171E/26670171C	26670211E/26670211C	26670241E/26670241C	85	25	-	22.2
26670112E/26670112C	26670142E/26670142C	26670172E/26670172C	26670212E/26670212C	26670242E/26670242C	85	25	M10x1.5	-
26670113E/26670113C	26670143E/26670143C	26670173E/26670173C	26670213E/26670213C	26670243E/26670243C	85	25	M10x1.25	-
26670114E/26670114C	26670144E/26670144C	26670174E/26670174C	26670214E/26670214C	26670244E/26670244C	85	25	M14x2	-
26670115E/26670115C	26670145E/26670145C	26670175E/26670175C	26670215E/26670215C	26670245E/26670245C	85	25	5/8"-11	-
26670116E/26670116C	26670146E/26670146C	26670176E/26670176C	26670216E/26670216C	26670246E/26670246C	100	25	-	22.2
26670117E/26670117C	26670147E/26670147C	26670177E/26670177C	26670217E/26670217C	26670247E/26670247C	100	25	M10x1.5	-
26670118E/26670118C	26670148E/26670148C	26670178E/26670178C	26670218E/26670218C	26670248E/26670248C	100	25	M10x1.25	-
26670119E/26670119C	26670149E/26670149C	26670179E/26670179C	26670219E/26670219C	26670249E/26670249C	100	25	M14x2	-
26670120E/26670120C	26670150E/26670150C	26670180E/26670180C	26670220E/26670220C	26670250E/26670250C	100	25	5/8"-11	-
26670121E/26670121C	26670151E/26670151C	26670181E/26670181C	26670221E/26670221C	26670251E/26670251C	125	30	-	22.2
26670122E/26670122C	26670152E/26670152C	26670182E/26670182C	26670222E/26670222C	26670252E/26670252C	125	30	M10x1.5	-
26670123E/26670123C	26670153E/26670153C	26670183E/26670183C	26670223E/26670223C	26670253E/26670253C	125	30	M10x1.25	-
26670124E/26670124C	26670154E/26670154C	26670184E/26670184C	26670224E/26670224C	26670254E/26670254C	125	30	M14x2	-
26670125E/26670125C	26670155E/26670155C	26670185E/26670185C	26670225E/26670225C	26670255E/26670255C	125	30	5/8"-11	-
26670126E/26670126C	26670156E/26670156C	26670186E/26670186C	26670226E/26670226C	26670256E/26670256C	150	30	5/8"-11	-
26670127E/26670127C	26670157E/26670157C	26670187E/26670187C	26670227E/26670227C	26670257E/26670257C	150	30	M10x1.5	-
26670128E/26670128C	26670158E/26670158C	26670188E/26670188C	26670228E/26670228C	26670258E/26670258C	150	30	M10x1.25	-
26670129E/26670129C	26670159E/26670159C	26670189E/26670189C	26670229E/26670229C	26670259E/26670259C	150	30	M14x2	-
26670130E/26670130C	26670160E/26670160C	26670190E/26670190C	26670230E/26670230C	26670260E/26670260C	150	30	5/8"-11	-

2667 / CRIMPED WIRE CUP BRUSH

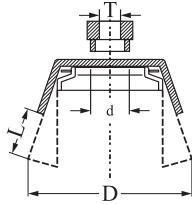

BRASS-COATED STEEL WIRE 0.35MM ITEM NO.	0.20MM ITEM NO.	STAINLESS STEEL WIRE 0.30MM ITEM NO.	0.35MM ITEM NO.	DIA. (MM)	TRIM LENGTH (MM)	SPECIFICATION T	ARBOR (MM)
26670261E/26670261C	26670301E/26670301C	26670331E/26670331C	26670361E/26670361C	65	20	-	16
26670262E/26670262C	26670302E/26670302C	26670332E/26670332C	26670362E/26670362C	65	20	M10x1.5	-
26670263E/26670263C	26670303E/26670303C	26670333E/26670333C	26670363E/26670363C	65	20	M10x1.25	-
26670264E/26670264C	26670304E/26670304C	26670334E/26670334C	26670364E/26670364C	65	20	M14x2	-
26670265E/26670265C	26670305E/26670305C	26670335E/26670335C	26670365E/26670365C	65	20	5/8"-11	-
26670266E/26670266C	26670306E/26670306C	26670336E/26670336C	26670366E/26670366C	75	25	-	22.2
26670267E/26670267C	26670307E/26670307C	26670337E/26670337C	26670367E/26670367C	75	25	M10x1.5	-
26670268E/26670268C	26670308E/26670308C	26670338E/26670338C	26670368E/26670368C	75	25	M10x1.25	-
26670269E/26670269C	26670309E/26670309C	26670339E/26670339C	26670369E/26670369C	75	25	M14x2	-
26670270E/26670270C	26670310E/26670310C	26670340E/26670340C	26670370E/26670370C	75	25	5/8"-11	-
26670271E/26670271C	26670311E/26670311C	26670341E/26670341C	26670371E/26670371C	80	25	-	22.2
26670272E/26670272C	26670312E/26670312C	26670342E/26670342C	26670372E/26670372C	80	25	M10x1.5	-
26670273E/26670273C	26670313E/26670313C	26670343E/26670343C	26670373E/26670373C	80	25	M10x1.25	-
26670274E/26670274C	26670314E/26670314C	26670344E/26670344C	26670374E/26670374C	80	25	M14x2	-
26670275E/26670275C	26670315E/26670315C	26670345E/26670345C	26670375E/26670375C	80	25	5/8"-11	-
26670276E/26670276C	26670316E/26670316C	26670346E/26670346C	26670376E/26670376C	100	25	-	22.2
26670277E/26670277C	26670317E/26670317C	26670347E/26670347C	26670377E/26670377C	100	25	M10x1.5	-
26670278E/26670278C	26670318E/26670318C	26670348E/26670348C	26670378E/26670378C	100	25	M10x1.25	-
26670279E/26670279C	26670319E/26670319C	26670349E/26670349C	26670379E/26670379C	100	25	M14x2	-
26670280E/26670280C	26670320E/26670320C	26670350E/26670350C	26670380E/26670380C	100	25	5/8"-11	-
26670281E/26670281C	26670321E/26670321C	26670351E/26670351C	26670381E/26670381C	125	30	-	22.2
26670282E/26670282C	26670322E/26670322C	26670352E/26670352C	26670382E/26670382C	125	30	M10x1.5	-
26670283E/26670283C	26670323E/26670323C	26670353E/26670353C	26670383E/26670383C	125	30	M10x1.25	-
26670284E/26670284C	26670324E/26670324C	26670354E/26670354C	26670384E/26670384C	125	30	M14x2	-
26670285E/26670285C	26670325E/26670325C	26670355E/26670355C	26670385E/26670385C	125	30	5/8"-11	-
26670286E/26670286C	26670326E/26670326C	26670356E/26670356C	26670386E/26670386C	150	30	5/8"-11	-
26670287E/26670287C	26670327E/26670327C	26670357E/26670357C	26670387E/26670387C	150	30	M10x1.5	-
26670288E/26670288C	26670328E/26670328C	26670358E/26670358C	26670388E/26670388C	150	30	M10x1.25	-
26670289E/26670289C	26670329E/26670329C	26670359E/26670359C	26670389E/26670389C	150	30	M14x2	-
26670290E/26670290C	26670330E/26670330C	26670360E/26670360C	26670390E/26670390C	150	30	5/8"-11	-

2675 / STEM MOUNTED CRIMPED WIRE CUP BRUSH

- Highly flexible, enabling optimal adjustment to workpiece contours.
- Ideal for brushing uneven surfaces.
- Used for light to medium duty brushing action such as removal of light scale, dirt, rust, corrosion and light burrs.
- Designed for use on straight grinders and power drills.

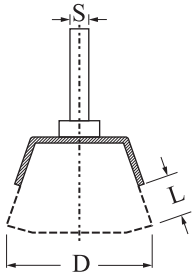

TEMPERED STEEL WIRE		BRASS-COATED STEEL WIRE		STAINLESS STEEL WIRE		SPECIFICATION		
0.20MM ITEM NO.	0.30MM ITEM NO.	0.20MM ITEM NO.	0.30MM ITEM NO.	0.30MM ITEM NO.	0.30MM ITEM NO.	DIA. (MM)	TRIM LENGTH (MM)	ARBOR (MM)
26750101E/26750101C	26750131E/26750131C	26750201E/26750201C	26750231E/26750231C	26750301E/26750301C	26750301E/26750301C	40	15	6
26750102E/26750102C	26750132E/26750132C	26750202E/26750202C	26750232E/26750232C	26750302E/26750302C	26750302E/26750302C	50	20	6
26750103E/26750103C	26750133E/26750133C	26750203E/26750203C	26750233E/26750233C	26750303E/26750303C	26750303E/26750303C	63	20	6
26750104E/26750104C	26750134E/26750134C	26750204E/26750204C	26750234E/26750234C	26750304E/26750304C	26750304E/26750304C	75	25	6
26750105E/26750105C	26750135E/26750135C	26750205E/26750205C	26750235E/26750235C	26750305E/26750305C	26750305E/26750305C	100	25	6

2620 / STEM MOUNTED CRIMPED WIRE WHEEL BRUSH

- Designed for individual use in confined areas.
- Best suited for brushing uneven surfaces and areas inaccessible to wider brushes.
- Used for light to medium duty brushing action such as removal of light scale, dirt, rust, corrosion and light burrs.
- Highly flexible, enabling optimal adjustment to workpiece contours.
- Designed for use on straight grinders and power drills.

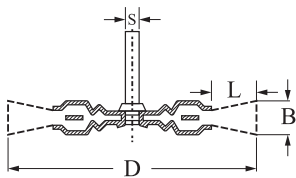

TEMPERED STEEL WIRE		BRASS-COATED STEEL WIRE		STAINLESS STEEL WIRE		SPECIFICATION			
0.20MM ITEM NO.	0.30MM ITEM NO.	0.20MM ITEM NO.	0.30MM ITEM NO.	0.30MM ITEM NO.	0.30MM ITEM NO.	DIA. (MM)	FACE WIDTH (MM)	TRIM LENGTH (MM)	ARBOR (MM)
26200101E/26200101C	26200131E/26200131C	26200201E/26200201C	26200231E/26200231C	26200301E/26200301C	26200301E/26200301C	38	5	10	6
26200102E/26200102C	26200132E/26200132C	26200202E/26200202C	26200232E/26200232C	26200302E/26200302C	26200302E/26200302C	50	5	10	6
26200103E/26200103C	26200133E/26200133C	26200203E/26200203C	26200233E/26200233C	26200303E/26200303C	26200303E/26200303C	63	6	13	6
26200104E/26200104C	26200134E/26200134C	26200204E/26200204C	26200234E/26200234C	26200304E/26200304C	26200304E/26200304C	75	8	16	6
26200105E/26200105C	26200135E/26200135C	26200205E/26200205C	26200235E/26200235C	26200305E/26200305C	26200305E/26200305C	100	8	22	6

2668 / CRIMPED WIRE WHEEL BRUSH, MULTIPLE ROW

- Highly flexible, enabling optimal adjustment to workpiece contours.
- Ideal for cleaning metal surfaces, blending surfaces, removing light burrs, paint, rust and corrosion.
- Multiple row are best for treating larger surface areas.

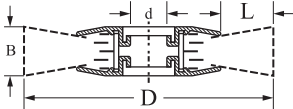

TEMPERED STEEL WIRE		BRASS-COATED STEEL WIRE		STAINLESS STEEL WIRE		SPECIFICATION			
0.30MM ITEM NO.	0.35MM ITEM NO.	0.30MM ITEM NO.	0.30MM ITEM NO.	0.30MM ITEM NO.	DIA. (MM)	TRIM LENGTH (MM)	B (MM)	ARBOR (MM)	
26680101E/26680101C	26680131E/26680131C	26680201E/26680201C	26680301E/26680301C	75	16	17	16		
26680102E/26680102C	26680132E/26680132C	26680202E/26680202C	26680302E/26680302C	100	16-20	17	20		
26680103E/26680103C	26680133E/26680133C	26680203E/26680203C	26680303E/26680303C	125	18-25	30	20		
26680104E/26680104C	26680134E/26680134C	26680204E/26680204C	26680304E/26680304C	150	18-25	30	32		
26680105E/26680105C	26680135E/26680135C	26680205E/26680205C	26680305E/26680305C	175	20-25	32	32		
26680106E/26680106C	26680136E/26680136C	26680206E/26680206C	26680306E/26680306C	200	20-25	42	32		
26680107E/26680107C	26680137E/26680137C	26680207E/26680207C	26680307E/26680307C	250	20-25	47	50.8		
26680108E/26680108C	26680138E/26680138C	26680208E/26680208C	26680308E/26680308C	300	30	60	50.8		

2678 / CRIMPED WIRE WHEEL BRUSH

- Ideal for cleaning metal surfaces, blending surfaces, removing light burrs, paint, rust and corrosion.
- Flexible for light to medium duty jobs and irregular surfaces.

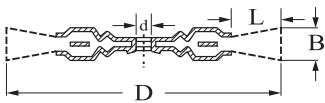

TEMPERED STEEL WIRE		BRASS-COATED STEEL WIRE		STAINLESS STEEL WIRE		SPECIFICATION			
0.20MM ITEM NO.	0.30MM ITEM NO.	0.35MM ITEM NO.	0.20MM ITEM NO.	0.30MM ITEM NO.	DIA. (MM)	TRIM LENGTH (MM)	B (MM)	ARBOR (MM)	
26780101E/26780101C	26780131E/26780131C	26780161E/26780161C	26780201E/26780201C	26780231E/26780231C	75	8	16	12.7	
26780102E/26780102C	26780132E/26780132C	26780162E/26780162C	26780202E/26780202C	26780232E/26780232C	100	10	22	20	
26780103E/26780103C	26780133E/26780133C	26780163E/26780163C	26780203E/26780203C	26780233E/26780233C	125	13	19	20	
26780104E/26780104C	26780134E/26780134C	26780164E/26780164C	26780204E/26780204C	26780234E/26780234C	150	13	35	32	
26780105E/26780105C	26780135E/26780135C	26780165E/26780165C	26780205E/26780205C	26780235E/26780235C	175	13	40	32	
26780106E/26780106C	26780136E/26780136C	26780166E/26780166C	26780206E/26780206C	26780236E/26780236C	200	15	42	32	
26780107E/26780107C	26780137E/26780137C	26780167E/26780167C	26780207E/26780207C	26780237E/26780237C	250	20	47	32	

2638 / SANDPAPER SHEET



APPLICATIONS:

- For removing paint from metal and wood.

FEATURES:

- Long life, particularly to tear-resistant.
- Fits all circumferences and forms.
- For types of different applications.
- Excellent surface finish on workpiece.

ITEM NO.	SIZE (MM)	ABRASIVE	GRIT
26380301E	230x280	aluminum oxide	40
26380302E	230x280	aluminum oxide	60
26380303E	230x280	aluminum oxide	80
26380304E	230x280	aluminum oxide	100
26380305E	230x280	aluminum oxide	120
26380306E	230x280	aluminum oxide	150

ITEM NO.	SIZE (MM)	ABRASIVE	GRIT
26380307E	230x280	aluminum oxide	180
26380308E	230x280	aluminum oxide	220
26380309E	230x280	aluminum oxide	240
26380310E	230x280	aluminum oxide	280
26380311E	230x280	aluminum oxide	400

2642 / SANDPAPER SHEET, WATERPROOF



APPLICATIONS:

- For work on paints and glass. Especially for all wet grinding on conventional paints.

FEATURES:

- Long life, particularly to tear-resistant.
- Fits all circumferences and forms.
- For types of different applications.
- Excellent surface finish on workpiece.

ITEM NO.	SIZE (MM)	ABRASIVE	GRIT
26420301E	230x280	Silicon Carbide	100
26420302E	230x280	Silicon Carbide	120
26420303E	230x280	Silicon Carbide	150

ITEM NO.	SIZE (MM)	ABRASIVE	GRIT
26420304E	230x280	Silicon Carbide	180
26420305E	230x280	Silicon Carbide	220
26420306E	230x280	Silicon Carbide	240

2642 / SANDPAPER SHEET, WATERPROOF

ITEM NO.	SIZE (MM)	ABRASIVE	GRIT
26420307E	230x280	Silicon Carbide	280
26420308E	230x280	Silicon Carbide	320
26420309E	230x280	Silicon Carbide	360
26420310E	230x280	Silicon Carbide	400
26420311E	230x280	Silicon Carbide	500

ITEM NO.	SIZE (MM)	ABRASIVE	GRIT
26420312E	230x280	Silicon Carbide	600
26420313E	230x280	Silicon Carbide	800
26420314E	230x280	Silicon Carbide	1000
26420315E	230x280	Silicon Carbide	1200

2697 / ALUMINUM OXIDE DELTA SANDING SHEETS



APPLICATIONS:

- Perfect for multi-purpose sanding projects with hard woods such as oak and pine or building boards like plywood.

FEATURES:

- Premium resin-bonded aluminum oxide open coat.
- 6-hole for dust extraction.
- Resin on resin bond.
- Front-side punching enhances dust control.

ITEM NO.	SIZE (INCH / MM)	GRIT
26970302E	3-1/2"x3-1/2" 90x90x90mm	40
26970303E	3-1/2"x3-1/2" 90x90x90mm	60
26970304E	3-1/2"x3-1/2" 90x90x90mm	80
26970305E	3-1/2"x3-1/2" 90x90x90mm	120
26970306E	3-1/2"x3-1/2" 90x90x90mm	180
26970307E	3-1/2"x3-1/2" 90x90x90mm	240
26970308E	3-5/8"x3-5/8" 93x93x93mm	40
26970309E	3-5/8"x3-5/8" 93x93x93mm	60

ITEM NO.	DIAMETER (INCH / MM)	GRIT
26970310E	3-5/8"x3-5/8" 93x93x93mm	80
26970311E	3-5/8"x3-5/8" 93x93x93mm	120
26970312E	3-5/8"x3-5/8" 93x93x93mm	180
26970313E	3-5/8"x3-5/8" 93x93x93mm	240
26970314E	3-3/4"x3-3/4" 95x95x95mm	40
26970315E	3-3/4"x3-3/4" 95x95x95mm	60
26970316E	3-3/4"x3-3/4" 95x95x95mm	80
26970317E	3-3/4"x3-3/4" 95x95x95mm	120

ITEM NO.	DIAMETER (INCH / MM)	GRIT
26970318E	3-3/4"x3-3/4" 95x95x95mm	180
26970319E	3-3/4"x3-3/4" 95x95x95mm	240
26970320E	4-1/8"x4-1/8" 105x105x105mm	40
26970321E	4-1/8"x4-1/8" 105x105x105mm	60
26970322E	4-1/8"x4-1/8" 105x105x105mm	80
26970323E	4-1/8"x4-1/8" 105x105x105mm	120
26970324E	4-1/8"x4-1/8" 105x105x105mm	180
26970325E	4-1/8"x4-1/8" 105x105x105mm	240

2649 / ALUMINUM OXIDE DETAIL SANDING SHEETS



APPLICATIONS:

- For use on wood, drywall, fiberglass, metal and painted surface.
- Fits Black & Decker Mouse Detail Sander as well as detail hand sander.

FEATURES:

- Premium resin-bonded aluminum oxide grain.
- Resin on resin bond to resist heat and humidity for longer life.
- Front-side punching enhances dust control.
- Sheets are designed to allow you to sand in corners and tight spaces.
- The quick-change hook and loop holding system allows for faster sheet changes.

ITEM NO.	SIZE (INCH / MM)	GRIT
26490361E	3-1/16"x1-7/8" 78x78x48mm	40
26490362E	3-1/16"x1-7/8" 78x78x48mm	60
26490363E	3-1/16"x1-7/8" 78x78x48mm	80
26490364E	3-1/16"x1-7/8" 78x78x48mm	120
26490365E	3-1/16"x1-7/8" 78x78x48mm	180
26490366E	3-1/16"x1-7/8" 78x78x48mm	240
26490367E	5"x3-9/16" 125x125x89mm	40
26490368E	5"x3-9/16" 125x125x89mm	60

ITEM NO.	DIAMETER (INCH / MM)	GRIT
26490369E	5"x3-9/16" 125x125x89mm	80
26490370E	5"x3-9/16" 125x125x89mm	120
26490371E	5"x3-9/16" 125x125x89mm	180
26490372E	5"x3-9/16" 125x125x89mm	240
26490373E	5-7/16"x3-11/16" 138x138x94mm	40
26490374E	5-7/16"x3-11/16" 138x138x94mm	60
26490375E	5-7/16"x3-11/16" 138x138x94mm	80
26490376E	5-7/16"x3-11/16" 138x138x94mm	120

ITEM NO.	DIAMETER (INCH / MM)	GRIT
26490377E	5-7/16"x3-11/16" 138x138x94mm	180
26490378E	5-7/16"x3-11/16" 138x138x94mm	240
26490379E	5-1/2"x3-9/16" 140x140x90mm	40
26490380E	5-1/2"x3-9/16" 140x140x90mm	60
26490381E	5-1/2"x3-9/16" 140x140x90mm	80
26490382E	5-1/2"x3-9/16" 140x140x90mm	120
26490383E	5-1/2"x3-9/16" 140x140x90mm	180
26490384E	5-1/2"x3-9/16" 140x140x90mm	240



2648 / MESH SANDING DISCS



APPLICATIONS:

- Ideal for leveling and heavy stock or paint removal.
- Can be used on wood, metal, acrylic, paint, polyester and fiberglass.

FEATURES:

- Premium aluminum oxide grit blend for fast material removal and long sanding life.
- Clog-reducing net design for less dust build-up and longer sanding life.
- Unique mesh construction excellent for moving dust away from sanding surfaces with or without dust extraction.
- Woven mesh backing works with hook and loop attachment for machines or hand sanding.

ITEM NO.	DIAMETER (INCH / MM)	GRIT
26480301E	5" 125mm	80
26480302E	5" 125mm	120
26480303E	5" 125mm	180
26480304E	5" 125mm	220
26480305E	5" 125mm	240

ITEM NO.	DIAMETER (INCH / MM)	GRIT
26480306E	5" 125mm	320
26480307E	5" 125mm	400
26480308E	6" 150mm	80
26480309E	6" 150mm	120
26480310E	6" 150mm	180

ITEM NO.	DIAMETER (INCH / MM)	GRIT
26480311E	6" 150mm	220
26480312E	6" 150mm	240
26480313E	6" 150mm	320
26480314E	6" 150mm	400



2646 / VELCRO SANDING PAPER DISCS WITH 6 HOLES, ALUMINUM OXIDE



APPLICATIONS:

- For use on metals, woods and paints.
- Only use with backing pad.

FEATURES:

- 6 hole design pattern for fast and precise alignment on 6 hole sanders.
- A perfect fit to surfaces and contours through the adhesive discs flexibility.
- A faster tool change because of backing pads velcro layer.

ITEM NO.	DIAMETER (INCH / MM)	GRIT
26460301E	5" 125mm	40
26460302E	5" 125mm	60
26460303E	5" 125mm	80
26460304E	5" 125mm	100
26460305E	5" 125mm	120
26460306E	5" 125mm	150
26460307E	5" 125mm	180
26460308E	5" 125mm	220

ITEM NO.	DIAMETER (INCH / MM)	GRIT
26460309E	5" 125mm	240
26460310E	5" 125mm	320
26460311E	5" 125mm	400
26460312E	6" 150mm	40
26460313E	6" 150mm	60
26460314E	6" 150mm	80
26460315E	6" 150mm	100

ITEM NO.	DIAMETER (INCH / MM)	GRIT
26460316E	6" 150mm	120
26460317E	6" 150mm	150
26460318E	6" 150mm	180
26460319E	6" 150mm	220
26460320E	6" 150mm	280
26460321E	6" 150mm	320
26460322E	6" 150mm	400

2647 / VELCRO SANDING PAPER DISCS WITH 5 HOLES, ALUMINUM OXIDE



APPLICATIONS:

- For use on metals, woods and paints.
- Only use with backing pad.

FEATURES:

- With 5 holes, fit 5-hole random orbit sander.
- A perfect fit to surfaces and contours through the adhesive discs flexibility.
- A faster tool change because of backing pads velcro layer.

ITEM NO.	DIAMETER (INCH / MM)	GRIT
26470301E	5" 125mm	40

ITEM NO.	DIAMETER (INCH / MM)	GRIT
26470302E	5" 125mm	60

ITEM NO.	DIAMETER (INCH / MM)	GRIT
26470303E	5" 125mm	80

2647 / VELCRO SANDING PAPER DISCS WITH 5 HOLES, ALUMINUM OXIDE

ITEM NO.	DIAMETER (INCH / MM)	GRIT	ITEM NO.	DIAMETER (INCH / MM)	GRIT	ITEM NO.	DIAMETER (INCH / MM)	GRIT
26470304E	5" 125mm	120	26470309E	6" 150mm	80	26470313E	6" 150mm	180
26470305E	5" 125mm	180	26470310E	6" 150mm	100	26470314E	6" 150mm	240
26470306E	5" 125mm	220	26470311E	6" 150mm	120	26470315E	6" 150mm	320
26470307E	6" 150mm	40	26470312E	6" 150mm	150	26470316E	6" 150mm	400
26470308E	6" 150mm	60						

2643 / VELCRO SANDING PAPER DISCS WITH 8 HOLES, ALUMINUM OXIDE



APPLICATIONS:

- For use on metals, woods and paints.
- Only use with backing pad.

FEATURES:

- 8 hole design pattern for fast and precise alignment on 8 hole sanders.
- A perfect fit to surfaces and contours through the adhesive discs flexibility.
- A faster tool change because of backing pads velcro layer.

ITEM NO.	DIAMETER (INCH / MM)	GRIT	ITEM NO.	DIAMETER (INCH / MM)	GRIT	ITEM NO.	DIAMETER (INCH / MM)	GRIT
26430301E	4-1/2" 115mm	40	26430311E	5" 125mm	80	26430320E	6" 150mm	80
26430302E	4-1/2" 115mm	60	26430312E	5" 125mm	100	26430321E	6" 150mm	100
26430303E	4-1/2" 115mm	80	26430313E	5" 125mm	120	26430322E	6" 150mm	120
26430304E	4-1/2" 115mm	100	26430314E	5" 125mm	150	26430323E	6" 150mm	150
26430305E	4-1/2" 115mm	120	26430315E	5" 125mm	180	26430324E	6" 150mm	180
26430306E	4-1/2" 115mm	150	26430316E	5" 125mm	220	26430325E	6" 150mm	220
26430307E	4-1/2" 115mm	180	26430317E	5" 125mm	240	26430326E	6" 150mm	280
26430308E	4-1/2" 115mm	220	26430318E	5" 125mm	320	26430327E	6" 150mm	320
26430309E	5" 125mm	40	26430319E	5" 125mm	400	26430328E	6" 150mm	400
26430310E	5" 125mm	60						

2659 / PRESSURE SENSITIVE ADHESIVE SANDING DISCS, SILICON CARBIDE



APPLICATIONS:

- For use on paint, primer, gel coat, metal, and wood.
- Only use with backing pad.

FEATURES:

- Pressure sensitive stick-on holding system resists slipping.
- Heavy duty paper resist tearing, lasts longer.
- Other available grain: Aluminum Oxide, Zirconium Oxide, (Gold) Aluminum Oxide.

ITEM NO.	DIAMETER (INCH / MM)	GRIT
26590301E	5" 125mm	40
26590302E	5" 125mm	60
26590303E	5" 125mm	80
26590304E	5" 125mm	100
26590305E	5" 125mm	120
26590306E	5" 125mm	150
26590307E	5" 125mm	180

ITEM NO.	DIAMETER (INCH / MM)	GRIT
26590308E	5" 125mm	220
26590309E	5" 125mm	240
26590310E	5" 125mm	320
26590311E	5" 125mm	400
26590312E	6" 150mm	80
26590313E	6" 150mm	100
26590314E	6" 150mm	120

ITEM NO.	DIAMETER (INCH / MM)	GRIT
26590315E	6" 150mm	150
26590316E	6" 150mm	180
26590317E	6" 150mm	220
26590318E	6" 150mm	280
26590319E	6" 150mm	320
26590320E	6" 150mm	400



2695 / ALUMINUM OXIDE RESIN FIBER DISCS

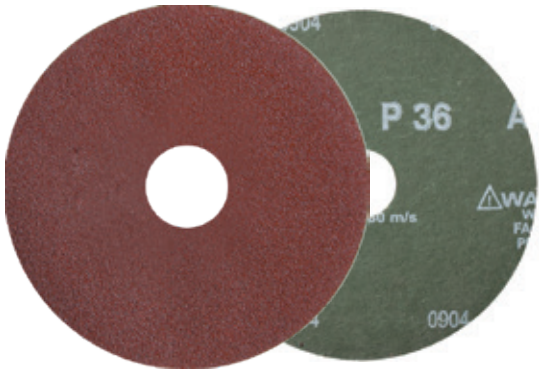

APPLICATIONS:

- For use with backer pad on angle grinder.
- For use on wood, metal, drywall, fiberglass and paint surfaces.

FEATURES:

- Aluminum Oxide grain.
- Vulcanized fibre backing.
- Resin on resin bond.
- Economical choice with consistent performance.
- Ideal fibre disc for wood.
- Wide range of grits to strip, grind, debur and polish.

ITEM NO.	DIAMETER (INCH / MM)	GRIT
26950301E	4"x5/8" 100x16mm	24
26950302E	4"x5/8" 100x16mm	36
26950303E	4"x5/8" 100x16mm	50
26950304E	4"x5/8" 100x16mm	60
26950305E	4"x5/8" 100x16mm	80
26950306E	4"x5/8" 100x16mm	120
26950307E	4-1/2"x7/8" 115x22.2mm	24
26950308E	4-1/2"x7/8" 115x22.2mm	36
26950309E	4-1/2"x7/8" 115x22.2mm	50
26950310E	4-1/2"x7/8" 115x22.2mm	60
26950311E	4-1/2"x7/8" 115x22.2mm	80
26950312E	4-1/2"x7/8" 115x22.2mm	100
26950313E	4-1/2"x7/8" 115x22.2mm	120
26950314E	5"x7/8" 125x22.2mm	16
26950315E	5"x7/8" 125x22.2mm	24

ITEM NO.	DIAMETER (INCH / MM)	GRIT
26950316E	5"x7/8" 125x22.2mm	36
26950317E	5"x7/8" 125x22.2mm	50
26950318E	5"x7/8" 125x22.2mm	60
26950319E	5"x7/8" 125x22.2mm	80
26950320E	5"x7/8" 125x22.2mm	100
26950321E	5"x7/8" 125x22.2mm	120
26950322E	6"x7/8" 150x22.2mm	16
26950323E	6"x7/8" 150x22.2mm	24
26950324E	6"x7/8" 150x22.2mm	36
26950325E	6"x7/8" 150x22.2mm	50
26950326E	6"x7/8" 150x22.2mm	60
26950327E	6"x7/8" 150x22.2mm	80
26950328E	6"x7/8" 150x22.2mm	100
26950329E	7"x7/8" 180x22.2mm	16
26950330E	7"x7/8" 180x22.2mm	24

ITEM NO.	DIAMETER (INCH / MM)	GRIT
26950331E	7"x7/8" 180x22.2mm	36
26950332E	7"x7/8" 180x22.2mm	50
26950333E	7"x7/8" 180x22.2mm	60
26950334E	7"x7/8" 180x22.2mm	80
26950335E	7"x7/8" 180x22.2mm	100
26950336E	7"x7/8" 180x22.2mm	120
26950337E	9"x7/8" 230x22.2mm	16
26950338E	9"x7/8" 230x22.2mm	24
26950339E	9"x7/8" 230x22.2mm	36
26950340E	9"x7/8" 230x22.2mm	50
26950341E	9"x7/8" 230x22.2mm	60
26950342E	9"x7/8" 230x22.2mm	80
26950343E	9"x7/8" 230x22.2mm	100
26950344E	9"x7/8" 230x22.2mm	120

2660 / ALUMINUM OXIDE SANDING BELTS

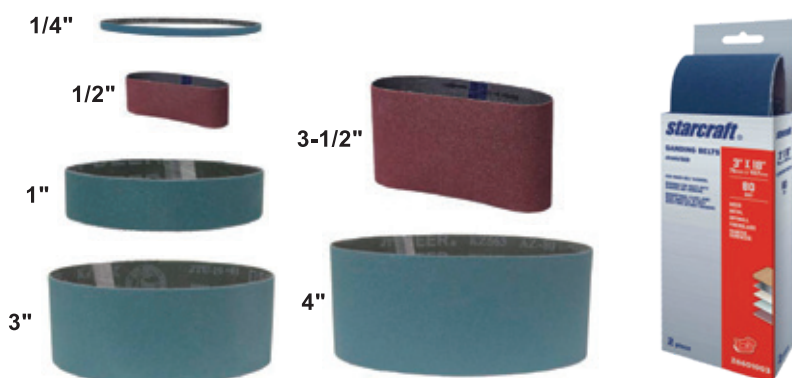

APPLICATIONS:

- For use on power belt sanders, portable file Sander, bench and backstand Sanders.
- For use on wood, metal, fiberglass, & paint surface.

FEATURES:

- Runs smoothly in both directions for longer life.
- Flexible ·J" weight cotton cloth back and Mylar tape seam joint resist stretching and assure smooth.bump-free sanding.
- Premium aluminum oxide grain and full resin bonding keep the belt flexible and heat and pressure resistant.

ITEM NO.	SIZE (INCH)	GRIT	ITEM NO.	DIAMETER (INCH)	GRIT	ITEM NO.	DIAMETER (INCH)	GRIT
26600306E	1" x 30"	50	26600303E	3"x18"	120	26600320E	4"x24"	40
26600307E	1" x 30"	80	26600313E	3"x21"	40	26600321E	4"x24"	50
26600308E	1" x 30"	120	26600314E	3"x21"	50	26600322E	4"x24"	80
26600309E	1" x 30"	220	26600305E	3"x21"	80	26600323E	4"x24"	120
26600310E	3"x18"	40	26600315E	3"x21"	120	26600324E	4"x36"	40
26600311E	3"x18"	50	26600316E	3"x24"	40	26600325E	4"x36"	50
26600302E	3"x18"	60	26600317E	3"x24"	50	26600326E	4"x36"	80
26600312E	3"x18"	80	26600318E	3"x24"	80	26600327E	4"x36"	120
26600304E	3"x18"	100	26600319E	3"x24"	120			

2718 / FLEXIBLE ABRASIVE SANDING SPONGES

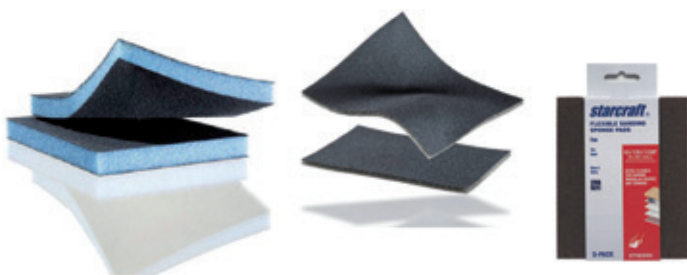

- Ultra flexible polyurethane foam provides for a soft sanding action on flat and contoured surfaces without sanding through coatings
- Alminum oxide grain, the best choice for sanding primer, sealer and between coats of finish on furniture and cabinets.
- Ideal for sanding sealer and wash coats in wood, and touching-up or repairing of primer.

ITEM NO.	SIZE (INCH / MM)	GRIT	ITEM NO.	SIZE (INCH / MM)	GRIT	ITEM NO.	SIZE (INCH / MM)	GRIT
27180301E	4-1/2" x 5-1/2" x 3/16" 114x140x5mm	60 Coarse	27180304E	4-1/2" x 5-1/2" x 3/8" 114x140x10mm	60 Coarse	27180307E	4-1/2" x 5-1/2" x 1/2" 114x140x12mm	60 Coarse
27180302E	4-1/2" x 5-1/2" x 3/16" 114x140x5mm	120 Medium	27180305E	4-1/2" x 5-1/2" x 3/8" 114x140x10mm	100 Medium	27180308E	4-1/2" x 5-1/2" x 1/2" 114x140x12mm	100 Medium
27180303E	4-1/2" x 5-1/2" x 3/16" 114x140x5mm	180 Fine	27180306E	4-1/2" x 5-1/2" x 3/8" 114x140x10mm	150 Fine	27180309E	4-1/2" x 5-1/2" x 1/2" 114x140x12mm	150 Fine

2719 / DRYWALL FOAM SANDING SPONGES



- For use on drywall, wood, metal, fiberglass & painted surfaces.
- Combines the performance of premium sandpaper with the convenience of a sanding sponge.
- Extra flexible for sanding irregular shapes, contours, and corners.
- Abrasive grit on all 4 sides - rotate for longer life.
- Resin bonding locks the grain to the foam sponge for longer life.

ITEM NO.	SIZE (INCH / MM)	GRIT	ITEM NO.	SIZE (INCH / MM)	GRIT	ITEM NO.	SIZE (INCH / MM)	GRIT
27190301E	3"x5"x1" 76x127x25mm	80	27190303E	3"x5"x1" 76x127x25mm	46/80 Coarse/Med	27190305E	3-5/16"x9"x1" 84x230x25mm	80/120 med/fine
27190302E	3"x5"x1" 76x127x25mm	120	27190304E	3" x 10" x 1" 76x254x25mm	80/120 med/fine	27190306E	3-5/16"x9"x1" 84x230x25mm	120/120 fine/fine

2720 / MULTI-PURPOSE SANDING SPONGES



- The aluminum oxide abrasive is one grit on the top and one side, and a different grit on the bottom and other side.
- Good for a wide variety of materials and sanding applications where moderate flexibility is needed.
- Medium to firm density open cell polyurethane foam provides uniform support and moderately aggressive cutting action while generating a smooth surface.
- Use on most materials.

ITEM NO.	SIZE (INCH / MM)	GRIT	ITEM NO.	SIZE (INCH / MM)	GRIT	ITEM NO.	SIZE (INCH / MM)	GRIT
27200301E	2-5/8"x3-7/8"x1" 67x96x25mm	46/80 Coarse/Med	27200305E	2-3/4"x3-3/4"x1" 70x95x25mm	36/80 Coarse/Med	27200309E	3" x 5" x 1" 75x125x25mm	40/80 Coarse/Med
27200302E	4-1/2" x 5-1/2" x 3/16" 114x140x5mm	80/80 Med/Med	27200306E	2-3/4"x3-3/4"x1" 70x95x25mm	80/80 Med/Med	27200310E	3" x 5" x 1" 75x125x25mm	80/120 Medium/Med
27200303E	4-1/2" x 5-1/2" x 3/16" 114x140x5mm	80/120 Med/Fine	27200307E	2-3/4"x3-3/4"x1" 70x95x25mm	80/120 Med/Fine	27200311E	3" x 5" x 1" 75x125x25mm	180/220 Fine/Fine
27200304E	4-1/2" x 5-1/2" x 3/16" 114x140x5mm	120/120 Fine/Fine	27200308E	2-3/4"x3-3/4"x1" 70x95x25mm	120/120 Fine/Fine			

2654 / FLAP DISCS, ZIRCONIA ALUMINA, FIBERGLASS BACKING



APPLICATIONS:

- Ideal for grinding, blending and finishing.
- For use on metal, stainless, aluminum.
- Uses with right angle or vertical shaft grinders.

FEATURES:

- Flat style (Type 27) discs has a smooth grinding action.
- Angled style (Type 29) disc has a high cut rate.

ITEM NO.	DIAMETER (INCH / MM)	GRIT
26540301E 26540301P	4-1/2" x 7/8" 115x22.2mm	36
26540302E 26540302P	4-1/2" x 7/8" 115x22.2mm	40
26540303E 26540303P	4-1/2" x 7/8" 115x22.2mm	60
26540304E 26540304P	4-1/2" x 7/8" 115x22.2mm	80
26540305E 26540305P	4-1/2" x 5/8"-11 /	36
26540306E 26540306P	4-1/2" x 5/8"-11 /	40
26540307E 26540307P	4-1/2" x 5/8"-11 /	60
26540308E 26540308P	4-1/2" x 5/8"-11 /	80
26540309E 26540309P	7" x 7/8" 180x22.2mm	36
26540310E 26540310P	7" x 7/8" 180x22.2mm	40
26540311E 26540311P	7" x 7/8" 180x22.2mm	60
26540312E 26540312P	7" x 7/8" 180x22.2mm	80
26540313E 26540313P	7" x 5/8"-11 /	36
26540314E 26540314P	7" x 5/8"-11 /	40
26540315E 26540315P	7" x 5/8"-11 /	60
26540316E 26540316P	7" x 5/8"-11 /	80

ITEM NO.	DIAMETER (INCH / MM)	GRIT
26540317E 26540317P	4" x 5/8" 100x16mm	36
26540318E 26540318P	4" x 5/8" 100x16mm	40
26540319E 26540319P	4" x 5/8" 100x16mm	60
26540320E 26540320P	4" x 5/8" 100x16mm	80
26540321E 26540321P	4" x 5/8" 100x16mm	120
26540322E 26540322P	4-1/2" x 7/8" 115x22.2mm	36
26540323E 26540323P	4-1/2" x 7/8" 115x22.2mm	40
26540324E 26540324P	4-1/2" x 7/8" 115x22.2mm	60
26540325E 26540325P	4-1/2" x 7/8" 115x22.2mm	80
26540326E 26540326P	4-1/2" x 7/8" 115x22.2mm	120
26540327E 26540327P	4-1/2" x 5/8"-11 /	36
26540328E 26540328P	4-1/2" x 5/8"-11 /	40
26540329E 26540329P	4-1/2" x 5/8"-11 /	60
26540330E 26540330P	4-1/2" x 5/8"-11 /	80
26540331E 26540331P	4-1/2" x 5/8"-11 /	120

ITEM NO.	DIAMETER (INCH / MM)	GRIT
26540332E 26540332P	5" x 7/8" 125x22.2mm	36
26540333E 26540333P	5" x 7/8" 125x22.2mm	40
26540334E 26540334P	5" x 7/8" 125x22.2mm	60
26540335E 26540335P	5" x 7/8" 125x22.2mm	80
26540336E 26540336P	5" x 7/8" 125x22.2mm	120
26540337E 26540337P	7" x 7/8" 180x22.2mm	36
26540338E 26540338P	7" x 7/8" 180x22.2mm	40
26540339E 26540339P	7" x 7/8" 180x22.2mm	60
26540340E 26540340P	7" x 7/8" 180x22.2mm	80
26540341E 26540341P	7" x 7/8" 180x22.2mm	120
26540342E 26540342P	7" x 5/8"-11 /	36
26540343E 26540343P	7" x 5/8"-11 /	40
26540344E 26540344P	7" x 5/8"-11 /	60
26540345E 26540345P	7" x 5/8"-11 /	80
26540346E 26540346P	7" x 5/8"-11 /	120

2656 / FLAP DISCS, ALUMINUM OXIDE, FIBERGLASS BACKING

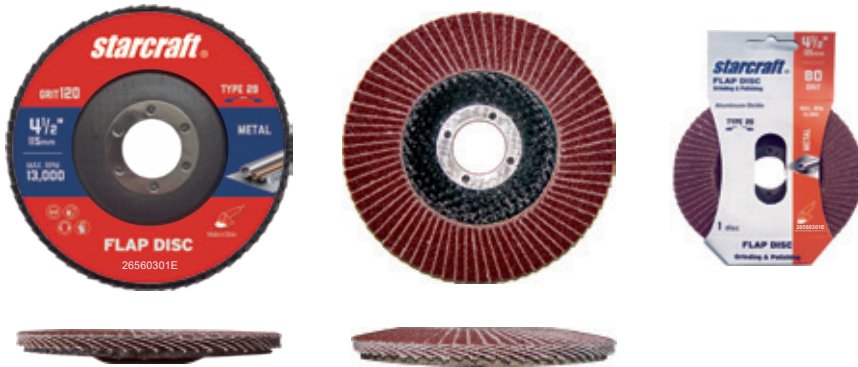

APPLICATIONS:

- Ideal for grinding, blending and finishing.
- For use on metal, aluminum, brass, bronze and fiberglass.
- Uses with right angle or vertical shaft grinders.

FEATURES:

- Flat style (Type 27) disc has a smooth grinding action.
- Angled style (Type 29) disc has a high cut rate.

ITEM NO.	DIAMETER (INCH / MM)	GRIT
26560301E 26560301P	4-1/2" x 7/8" 115x22.2mm	36
26560302E 26560302P	4-1/2" x 7/8" 115x22.2mm	40
26560303E 26560303P	4-1/2" x 7/8" 115x22.2mm	60
26560304E 26560304P	4-1/2" x 7/8" 115x22.2mm	80
26560305E 26560305P	4-1/2" x 5/8"-11 /	36
26560306E 26560306P	4-1/2" x 5/8"-11 /	40
26560307E 26560307P	4-1/2" x 5/8"-11 /	60
26560308E 26560308P	4-1/2" x 5/8"-11 /	80
26560309E 26560309P	7" x 7/8" 180x22.2mm	36
26560310E 26560310P	7" x 7/8" 180x22.2mm	40
26560311E 26560311P	7" x 7/8" 180x22.2mm	60
26560312E 26560312P	7" x 7/8" 180x22.2mm	80
26560313E 26560313P	7" x 5/8"-11 /	36
26560314E 26560314P	7" x 5/8"-11 /	40
26560315E 26560315P	7" x 5/8"-11 /	60
26560316E 26560316P	7" x 5/8"-11 /	80

ITEM NO.	DIAMETER (INCH / MM)	GRIT
26560317E 26560317P	4" x 5/8" 100x16mm	36
26560318E 26560318P	4" x 5/8" 100x16mm	40
26560319E 26560319P	4" x 5/8" 100x16mm	60
26560320E 26560320P	4" x 5/8" 100x16mm	80
26560321E 26560321P	4" x 5/8" 100x16mm	120
26560322E 26560322P	4-1/2" x 7/8" 115x22.2mm	36
26560323E 26560323P	4-1/2" x 7/8" 115x22.2mm	40
26560324E 26560324P	4-1/2" x 7/8" 115x22.2mm	60
26560325E 26560325P	4-1/2" x 7/8" 115x22.2mm	80
26560326E 26560326P	4-1/2" x 7/8" 115x22.2mm	120
26560327E 26560327P	4-1/2" x 5/8"-11 /	36
26560328E 26560328P	4-1/2" x 5/8"-11 /	40
26560329E 26560329P	4-1/2" x 5/8"-11 /	60
26560330E 26560330P	4-1/2" x 5/8"-11 /	80
26560331E 26560331P	4-1/2" x 5/8"-11 /	120

ITEM NO.	DIAMETER (INCH / MM)	GRIT
26560332E 26560332P	5" x 7/8" 125x22.2mm	36
26560333E 26560333P	5" x 7/8" 125x22.2mm	40
26560334E 26560334P	5" x 7/8" 125x22.2mm	60
26560335E 26560335P	5" x 7/8" 125x22.2mm	80
26560336E 26560336P	5" x 7/8" 125x22.2mm	120
26560337E 26560337P	7" x 7/8" 180x22.2mm	36
26560338E 26560338P	7" x 7/8" 180x22.2mm	40
26560339E 26560339P	7" x 7/8" 180x22.2mm	60
26560340E 26560340P	7" x 7/8" 180x22.2mm	80
26560341E 26560341P	7" x 7/8" 180x22.2mm	120
26560342E 26560342P	7" x 5/8"-11 /	36
26560343E 26560343P	7" x 5/8"-11 /	40
26560344E 26560344P	7" x 5/8"-11 /	60
26560345E 26560345P	7" x 5/8"-11 /	80
26560346E 26560346P	7" x 5/8"-11 /	120

2742 / FLAP DISCS, CERAMIC ALUMINA, FIBREGLASS BACKING

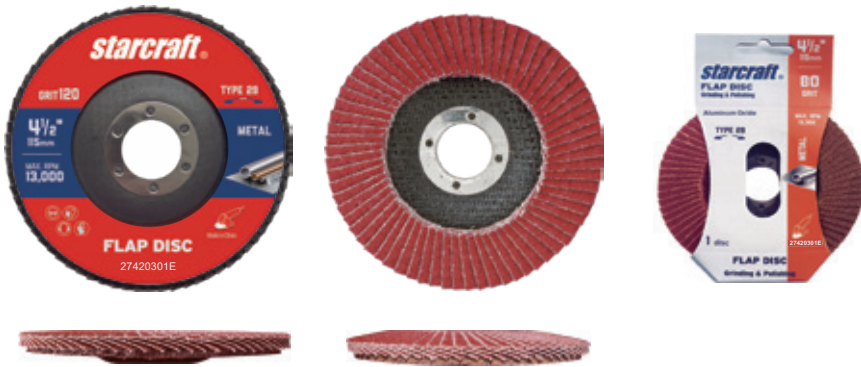

APPLICATIONS:

- For removing large amounts of material and for shaping or smoothing wood, metal, and masonry.
- Perfect for grinding downs welds and metal fabrication.
- For steel and stainless and other heat sensitive materials.

FEATURES:

- Self-sharpening high performance ceramic grain with a grinding aid for fast, aggressive cutting action.
- Polyester backing material for extra long life.
- Long service life than zirconia flap discs.
- Use with angle grinders.

ITEM NO.	DIAMETER (INCH / MM)	GRIT
27420301E 27420301P	4-1/2" x 7/8" 115x22.2mm	36
27420302E 27420302P	4-1/2" x 7/8" 115x22.2mm	40
27420303E 27420303P	4-1/2" x 7/8" 115x22.2mm	60
27420304E 27420304P	4-1/2" x 7/8" 115x22.2mm	80
27420305E 27420305P	4-1/2" x 5/8"-11 /	36
27420306E 27420306P	4-1/2" x 5/8"-11 /	40
27420307E 27420307P	4-1/2" x 5/8"-11 /	60
27420308E 27420308P	4-1/2" x 5/8"-11 /	80
27420309E 27420309P	7" x 7/8" 180x22.2mm	36
27420310E 27420310P	7" x 7/8" 180x22.2mm	40
27420311E 27420311P	7" x 7/8" 180x22.2mm	60
27420312E 27420312P	7" x 7/8" 180x22.2mm	80
27420313E 27420313P	7" x 5/8"-11 /	36
27420314E 27420314P	7" x 5/8"-11 /	40
27420315E 27420315P	7" x 5/8"-11 /	60
27420316E 27420316P	7" x 5/8"-11 /	80

ITEM NO.	DIAMETER (INCH / MM)	GRIT
27420317E 27420317P	4" x 5/8" 100x16mm	36
27420318E 27420318P	4" x 5/8" 100x16mm	40
27420319E 27420319P	4" x 5/8" 100x16mm	60
27420320E 27420320P	4" x 5/8" 100x16mm	80
27420321E 27420321P	4" x 5/8" 100x16mm	120
27420322E 27420322P	4-1/2" x 7/8" 115x22.2mm	36
27420323E 27420323P	4-1/2" x 7/8" 115x22.2mm	40
27420324E 27420324P	4-1/2" x 7/8" 115x22.2mm	60
27420325E 27420325P	4-1/2" x 7/8" 115x22.2mm	80
27420326E 27420326P	4-1/2" x 7/8" 115x22.2mm	120
27420327E 27420327P	4-1/2" x 5/8"-11 /	36
27420328E 27420328P	4-1/2" x 5/8"-11 /	40
27420329E 27420329P	4-1/2" x 5/8"-11 /	60
27420330E 27420330P	4-1/2" x 5/8"-11 /	80
27420331E 27420331P	4-1/2" x 5/8"-11 /	120

ITEM NO.	DIAMETER (INCH / MM)	GRIT
27420332E 27420332P	5" x 7/8" 125x22.2mm	36
27420333E 27420333P	5" x 7/8" 125x22.2mm	40
27420334E 27420334P	5" x 7/8" 125x22.2mm	60
27420335E 27420335P	5" x 7/8" 125x22.2mm	80
27420336E 27420336P	5" x 7/8" 125x22.2mm	120
27420337E 27420337P	7" x 7/8" 180x22.2mm	36
27420338E 27420338P	7" x 7/8" 180x22.2mm	40
27420339E 27420339P	7" x 7/8" 180x22.2mm	60
27420340E 27420340P	7" x 7/8" 180x22.2mm	80
27420341E 27420341P	7" x 7/8" 180x22.2mm	120
27420342E 27420342P	7" x 5/8"-11 /	36
27420343E 27420343P	7" x 5/8"-11 /	40
27420344E 27420344P	7" x 5/8"-11 /	60
27420345E 27420345P	7" x 5/8"-11 /	80
27420346E 27420346P	7" x 5/8"-11 /	120

A close-up photograph of a hand holding a glowing, golden orb. The hand is positioned in the upper left, with fingers curled around the orb. The orb emits a bright, warm light that illuminates the surrounding area, creating a soft glow. The background is dark and out of focus, suggesting an indoor setting with a window or light source. The overall mood is one of mystery and power.

Starcraft®

QUALITY · VALUE · INNOVATION

**Enjoy Work!
Enjoy Life!**

www.starcrafttools.com



Add: No. 880 Xingwen Road, Jiading, Shanghai, China
Tel: 0086-21-33517000, 33517100
Email: sales@starcraftgroup.com
Copyright © 2023